

# for roofers



**Why is the esb panel ideally suited for roofers?**

Constant high panel density over 620 kg/m<sup>3</sup> as well as the single-layer structure guarantee optimal static properties. The bending strength & E-modules in both directions in equal parts, enable an optimal panel yield when cutting, avoid planning & processing errors, as the confusion of main and secondary axis is excluded. This saves time & money. Added to this are the technical criteria of low swelling values & high screw and nail pull-out values. The easy roof nailing is often praised. Open & closed roof structures are feasible due to the panel's extensive diffusion openness. Due to its re-drying properties, the board is not very susceptible to mould. An easy-to-process tongue and groove design due to special milling compensates for minimal swelling. The boards are always sanded. The application of adhesives, paints & varnishes is possible after prior testing. When installed on the roof, it can withstand any downpour with taped joints due to the underlay certification of the ZVDH/Cologne for up to 6 weeks. **These are unique advantages!**

elka-holzwerke.de · 11/2023

## The application advantages:



Domestic spruce wood - naturally low in VOC

Minimum raw density 620 kg/m<sup>3</sup>

Bending strength & E-modulus equal in both directions for optimal panel yield

Mostly diffusion-open - suitable for open and closed construction methods

Processing and recycling-friendly due to adhesive without isocyanates

Splinter-free processing and sanded surface

High screw and nail withdrawal resistance

Can be used as sarking board N+F (UDPA) according to ZVDH/Köln



**elka -Holzwerke GmbH**

Hochwaldstraße 44  
54497 Morbach



Tel. +49 (0) 6533 / 956 332

Fax +49 (0) 6533 / 956 330

www.elka-holzwerke.de

vertriebsmarketing@elka-holzwerke.de



**Our qualified specialist retailer will be happy to advise you:**

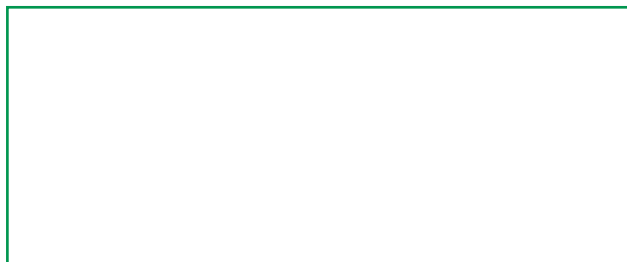

**More time... through elka variety and speed.**

Become a fan: /elka1906 /elka\_holzwerke



elka strong board

# for roofers

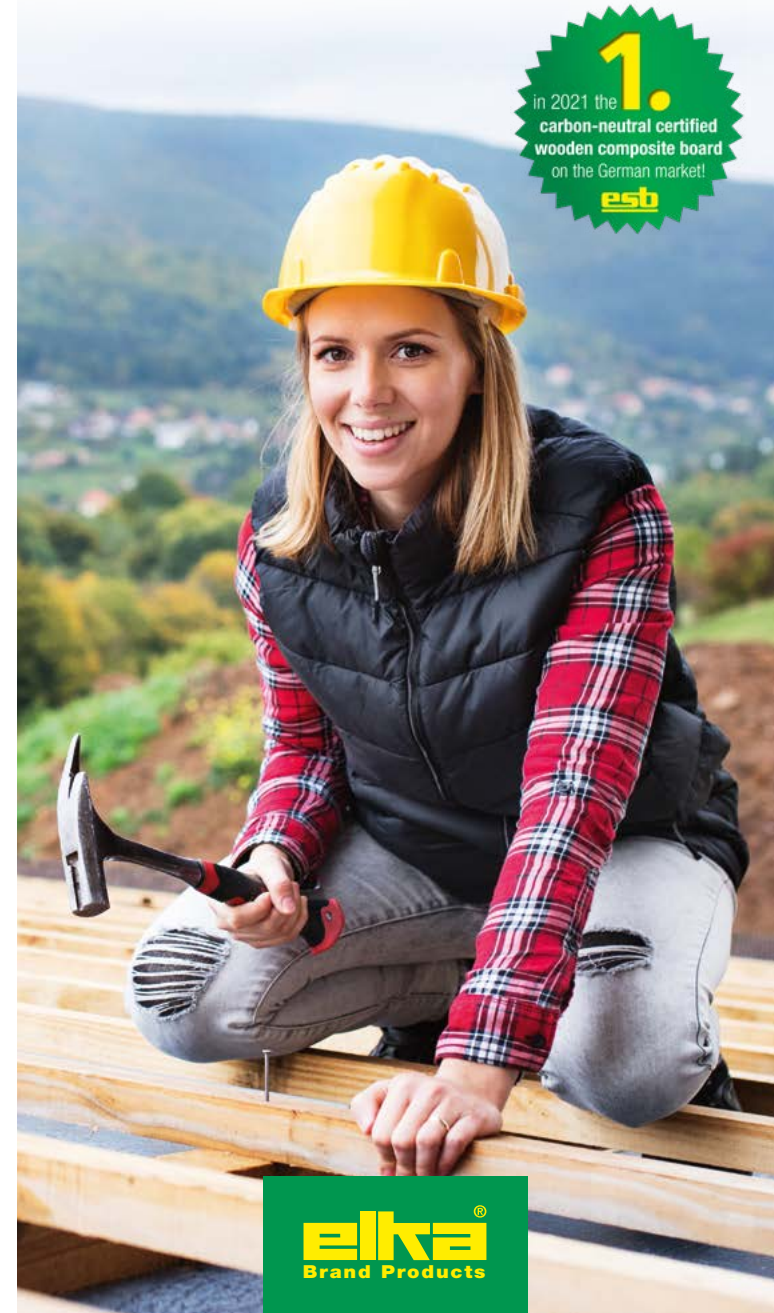



## The multi-talent board from the German eco-pioneer.

As a result of climate change and the generally increased environmental awareness, ecological criteria are of crucial importance today. As an ecological pioneer, elka-Holzwerke have been offering above-average quality standards with their branded products for decades.

The low-VOC esb spruce wood boards without reclaimed wood have a fresh, bright surface appearance and low emissions. The use of fresh wood is also tool-friendly and cost-saving.

### Our raw materials

Domestic woods from sustainably managed and regional forestry. The fresh wood chips used are generated in our own sawmill as well as the surrounding sawmills: Zero waste - no garbage - this is also a popular societal trend! Upon request, we provide PEFC certification.

### Our adhesive

Recycling-friendly and moisture-resistant MUF resin (Melamine-Urea-Formaldehyde resin), with a specially developed process to reduce formaldehyde emissions.

Formaldehyde content of  $\leq 0.05$  ppm (E1E05) complies with DIBt expert opinion on health protection G-160-18-0004. This board is also available as esb traverse.



## Example applications

### Roof - esb panel with high stiffening effect

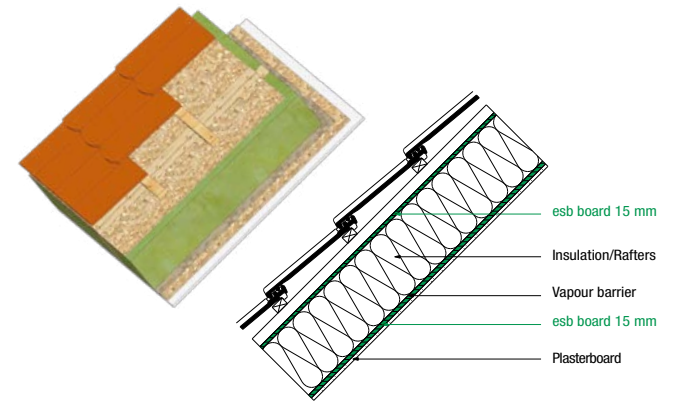

### Flat roof with ventilated roof cladding

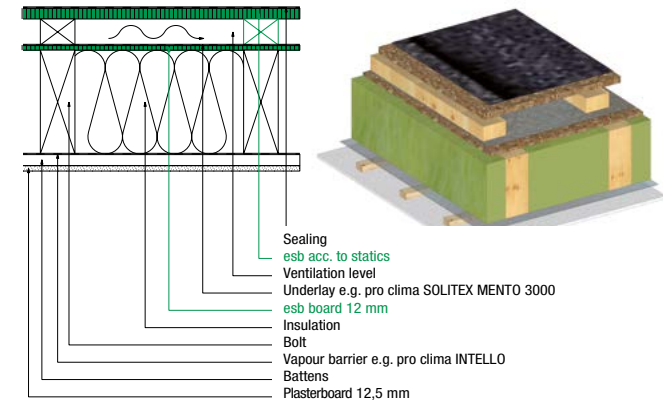

The shown exemplary superstructures in wall, ceiling and roof are exemplary illustration. They are not a substitute for the physical calculation in each individual case, taking into account all local conditions. The examples given represent information without any guarantee of properties.



DIBt-Gutachten No G-160-18-0004 in 2019

